

Pt100 RTD Sensor with Integral 4-20mA Transmitter



Made in the UK 

Description

A Pt100 temperature sensor with integral 4-20 mA transmitter and standard DIN Hirschmann connection.

The class A Pt100 element is housed in 6mm diameter rigid stem 316 stainless steel sheath, available in standard lengths of 50, 100 or 150mm long below hex of a ½" BSP process connection.

It has an integral 4-20mA transmitter housed in a 316 stainless steel body. The output is a loop powered (10 to 30 Volts dc) 4-20mA signal with a default range of 0 – 100°C and ambient operating temperature range of 0 to 75°C.

A DIN style Hirschmann connector is used for easy installation and replacement whilst maintaining reliability. The removable connector cable socket is IP65 rated and has a central fixing screw complete with PG7 cable gland suitable for 4.5 to 6mm diameter instrument wires.



Specification

Product	Pt100 Sensor with 4-20mA TX
Type	3 wire Class A Pt100
Temp Range	0 to 100 °C
Output	4 – 20 mA
Power Supply	10 to 30 Volts dc
Length	50, 100 or 150mm
Diameter Ø	6mm
Process Connection	½" BSP stainless steel
Material	316 stainless steel
Accuracy	0.2 °C ± 0.05 % reading
Part Number	RFHTX

Features

- Pt100 Class A accuracy
- Built-in 4-20mA transmitter
- Standard DIN connector
- 316 stainless steel
- 0 – 100°C standard range

Application

- Industrial Process Control
- HVAC
- OEM

Looking for something different?

Visit our custom made sensors page and have your sensors your way.



For more information visit:

sterlingsensors.co.uk



Sterling Sensors UK Ltd

Fitmec Works :: Hawksley Street :: Oldham
United Kingdom :: OL8 4PQ

T: +44 (0) 161 620 0410 F: +44 (0) 161 627 0507 E: sales@sterlingsensors.co.uk W: sterlingsensors.co.uk

Additional Information

Technical Drawing

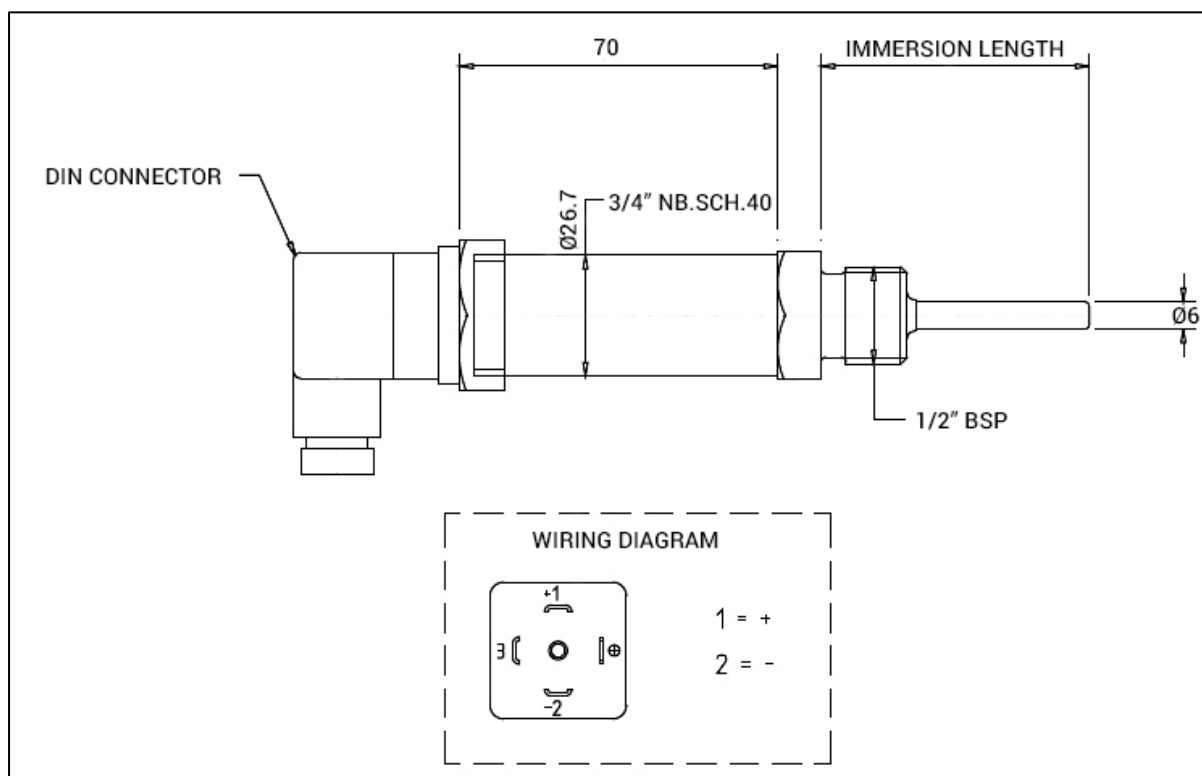

For more information visit:

sterlingsensors.co.uk