

# Standard RTD Connectors



## Description

Standard three pin RTD connectors for the termination of flexible, stranded or solid wires and mineral insulated cable. Suitable for use with 3-wire RTD circuits.

## Features

- High quality glass filled thermoplastic body
- Available with solid or hollow copper pins
- Short circuit prevention
- Sandwich construction connects and secures lead wires
- Stainless Steel screws
- White in colour

## Application

- Accepts wires up to 2.0mm with a maximum cable diameter of 8.0mm
- Temperature rating 200°C Max.
- For use with 3-wire RTD circuits

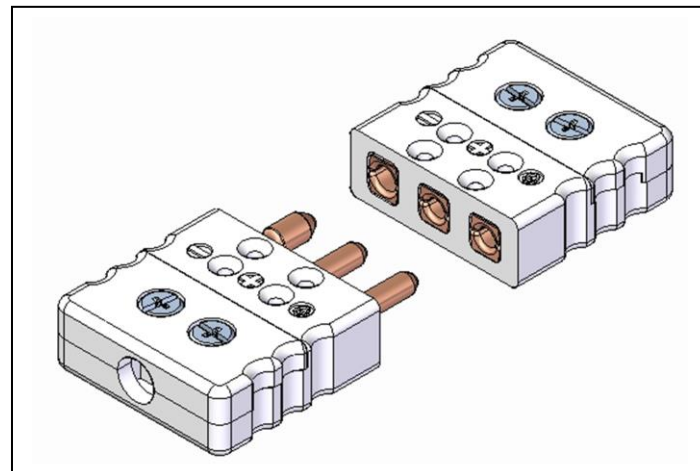
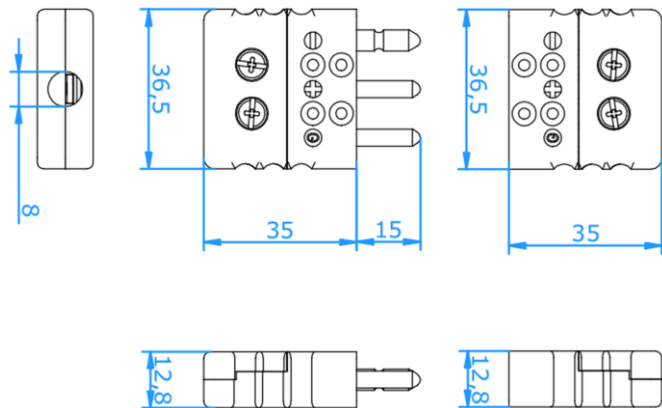

## Specification

Product	Standard RTD Connectors
Circuit	3-wire
Max. Temp	200°C
Wire Ø	Up to 2.0mm
Cable Ø	Up to 8.0mm
Colour	White
Pins	Copper (Cu) Available with hollow or solid pins

## Help & Advice

Our friendly sales team are here to help, offering expert advice



For more information visit:

[sterlingsensors.co.uk](http://sterlingsensors.co.uk)



**Sterling Sensors UK Ltd**

Fitmec Works ∷ Hawksley Street ∷ Oldham  
United Kingdom ∷ OL8 4PQ

T: +44 (0) 161 620 0410 F: +44 (0) 161 627 0507 E: [sales@sterlingsensors.co.uk](mailto:sales@sterlingsensors.co.uk) W: [sterlingsensors.co.uk](http://sterlingsensors.co.uk)